

UNIFICAZIONE

E NEL

24 30 F

DS 3200

Gennaio 1984
Ed.1 - 2/2

Carichi massimi di lavoro

T	500 kg
P	350 kg
L	400 kg

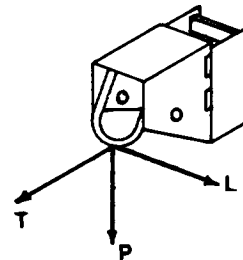

Calibri per le verifiche geometriche

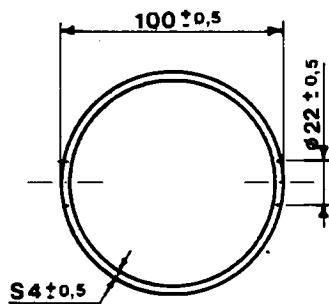
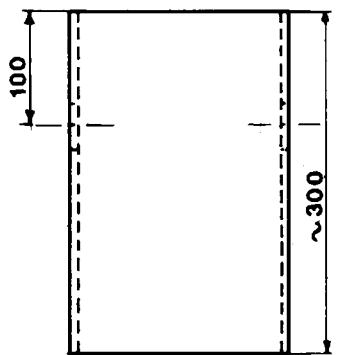

calibro (a)

Materiale: acciaio

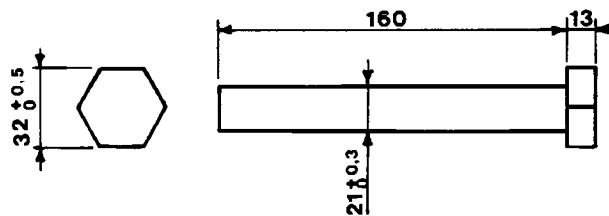

calibro (b)

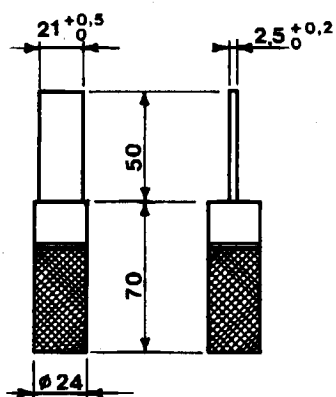

calibro (c)